

BERTO'S
the best catering equipment

Maxima900 cooking ranges

modello <u>model</u> modèle <u>Modell</u>	E9PQ2M	E9PQ4M	E9PQ6M
piastre quadre <u>square plates</u> plaques carrées <u>Viereckige Koch-Platten</u>	n. 2 Ø mm 300x300 kW 3,5	n. 4 Ø mm 300x300 kW 3,5	n. 6 Ø mm 300x300 kW 3,5
forno elettrico <u>electric oven</u> four électrique <u>Elektrobackofen</u>			
potenza totale <u>total heat input</u> puissance totale <u>Gesamtleistung</u>	kW 7	kW 14	kW 21
connessione elettrica <u>electric connection</u> branchement électrique <u>Elektrischer Anschluss</u>	V 400 - 415 3N ~	V 400 - 415 3N ~	V 400 - 415 3N ~
optional <u>option</u> <u>Sonderzubehör</u>	piastre 4 kW - plates 4 kW plaques 4 kW - Kochplatten 4 kW V 230 - 240 3 ~ porta - door - porte - Tür	piastre 4 kW - plates 4 kW plaques 4 kW - Kochplatten 4 kW V 230 - 240 3 ~ porte - doors - portes - Türen	piastre 4 kW - plates 4 kW plaques 4 kW - Kochplatten 4 kW V 230 - 240 3 ~ porte - doors - portes - Türen
dim. camera forno <u>cavity dimensions</u> dim. chambre <u>Abmessung Innenraum</u>			
dotazione griglie <u>grids supplies</u> fourniture de grilles <u>Mitgelieferte Roste</u>			
peso totale <u>total weight</u> poids total <u>Gesamtgewicht</u>	kg 48	kg 78	kg 108
cubatura <u>cubic volume</u> volume <u>Volumen</u>	m ³ 0,6	m ³ 1,03	m ³ 1,44

E9PQ2M

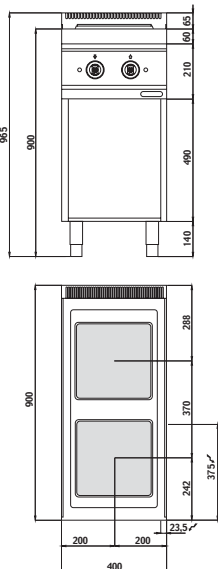

E9PQ4M

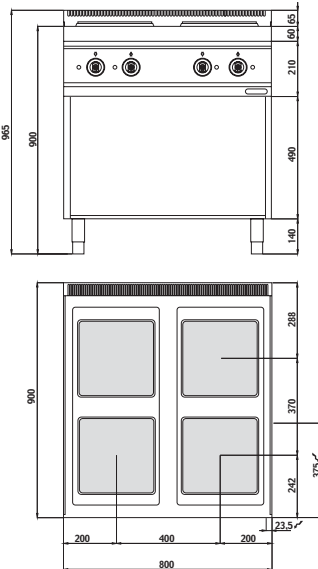

E9PQ6M

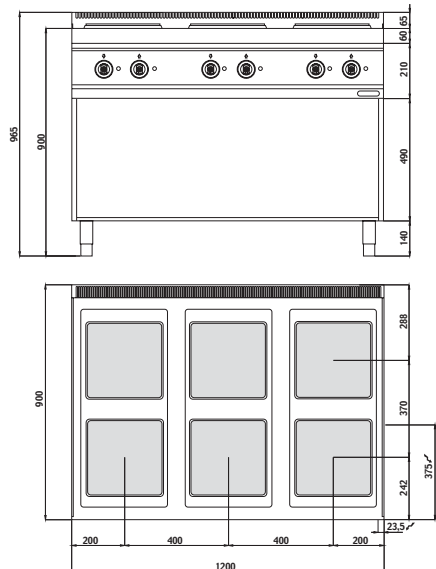

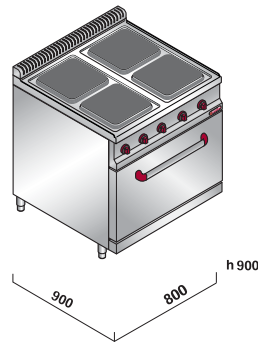
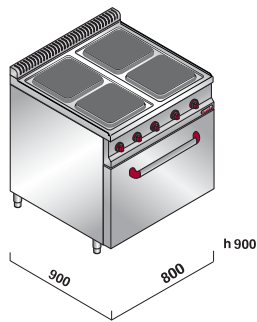

modello <u>model</u> <u>modèle</u> <u>Modell</u>	E9PQ4+FE1	E9PQ4+FE
piastre quadre <u>square</u> <u>plates</u> plaques carrées <u>Viereckige Koch-Platten</u>	n. 4 mm 300x300 kW 3,5	n. 4 mm 300x300 kW 3,5
forno elettrico <u>electric oven</u> four électrique <u>Elektrobackofen</u>	kW 3,5	kW 7,5
potenza totale <u>total heat input</u> puissance totale <u>Gesamtleistung</u>	kW 17,5	kW 21,5
connessione elettrica <u>electric connection</u> branchement électrique <u>Elektrischer Anschluss</u>	V 400 - 415 3N ~	V 400 - 415 3N ~
optional <u>option</u> <u>Sonderzubehör</u>	piastre 4 kW - plates 4 kW plaques 4 kW - Kochplatten 4 kW	piastre 4 kW - plates 4 kW plaques 4 kW - Kochplatten 4 kW
dim. camera forno <u>cavity dimensions</u> dim. chambre <u>Abmessung Innenraum</u>	mm 620x390x295h n. 4x 1/1 GN (n. 4x 600x400)	mm 685x550x295h n. 4x 2/1 GN
dotazione griglie <u>grids supplies</u> fourniture de grilles <u>Mitgelieferte Roste</u>	n. 1x 600x400	n. 1x 2/1 GN
peso totale <u>total weight</u> poids total <u>Gesamtgewicht</u>	kg 107	kg 127
cubatura <u>cubic volume</u> volume <u>Volumen</u>	m ³ 1,03	m ³ 1,03

E9PQ4+FE1

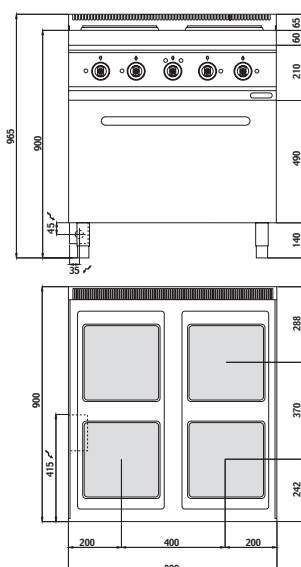

E9PQ4+FE

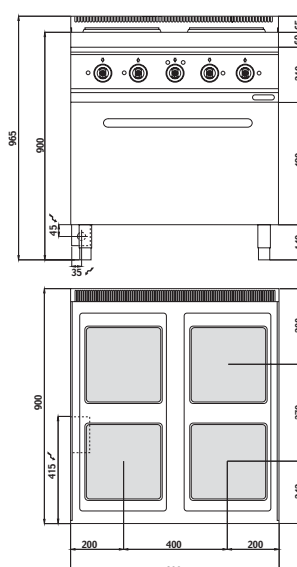

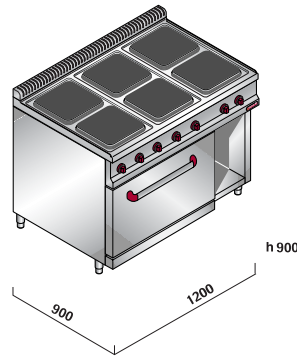
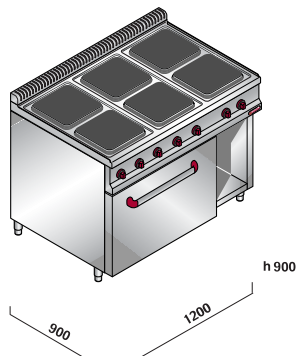

BERTO'S
the best catering equipment

modello <u>model</u> modèle <u>Modell</u>	E9PQ6+FE1		E9PQ6+FE	
piastre quadre <u>square plates</u> plaques carrées <u>Viereckige Koch-Platten</u>	n. 6 mm 300x300 kW 3,5		n. 6 mm 300x300 kW 3,5	
forno elettrico <u>electric oven</u> four électrique <u>Elektrobackofen</u>	kW 3,5		kW 7,5	
potenza totale <u>total heat input</u> puissance totale <u>Gesamtleistung</u>	kW 24,5		kW 28,5	
connessione elettrica <u>electric connection</u> branchement électrique <u>Elektrischer Anschluss</u>	V 400 - 415 3N ~		V 400 - 415 3N ~	
optional <u>option</u> <u>Sonderzubehör</u>	piastre 4 kW - plates 4 kW plaques 4 kW - Kochplatten 4 kW porta - door - porte - Tür		piastre 4 kW - plates 4 kW plaques 4 kW - Kochplatten 4 kW porta - door - porte - Tür	
dim. camera forno <u>cavity dimensions</u> dim. chambre <u>Abmessung Innenraum</u>	mm 620x390x295h n. 4x 1/1GN (n. 4x 600x400)		mm 685x550x295h n. 4x 2/1 GN	
dotazione griglie <u>grids supplies</u> fourniture de grilles <u>Mittelieferte Roste</u>	n. 1x 600x400		n. 1x 2/1 GN	
peso totale <u>total weight</u> poids total <u>Gesamtgewicht</u>	kg 146		kg 156	
cubatura <u>cubic volume</u> volume <u>Volumen</u>	m ³ 1,44		m ³ 1,44	

MaxiMa900 cooking ranges

E9PQ6+FE1

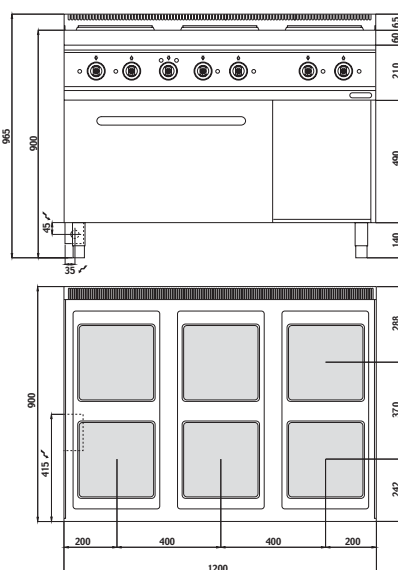

E9PQ6+FE

